

Der Haftreifenwechsel

1.

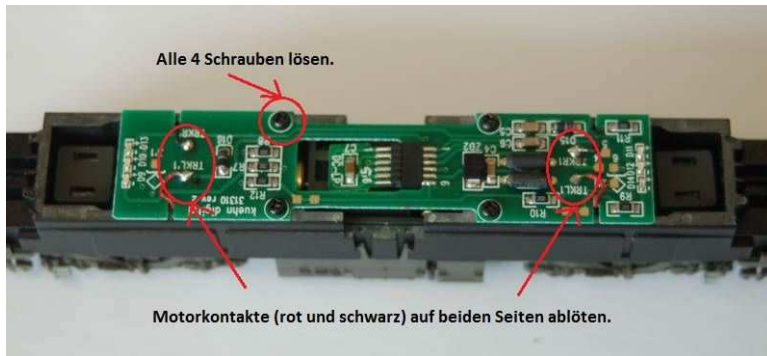

2.



3.

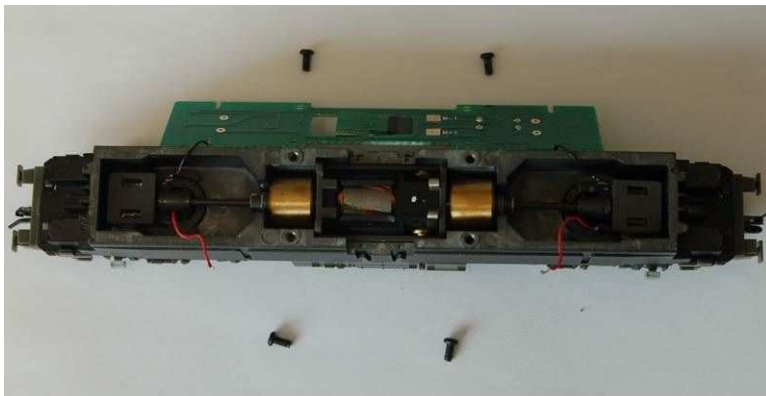

4.

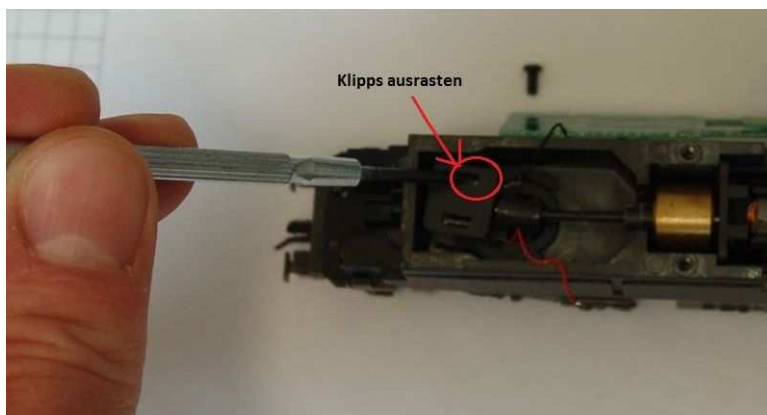

Der Haftreifenwechsel

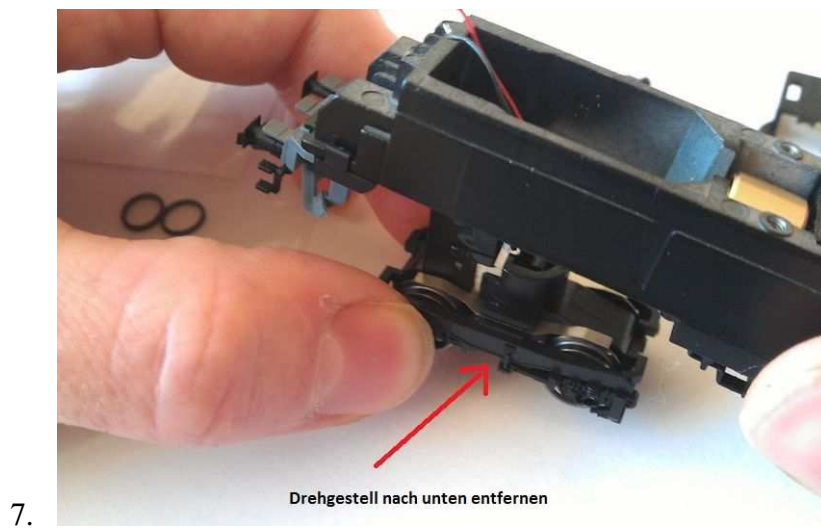
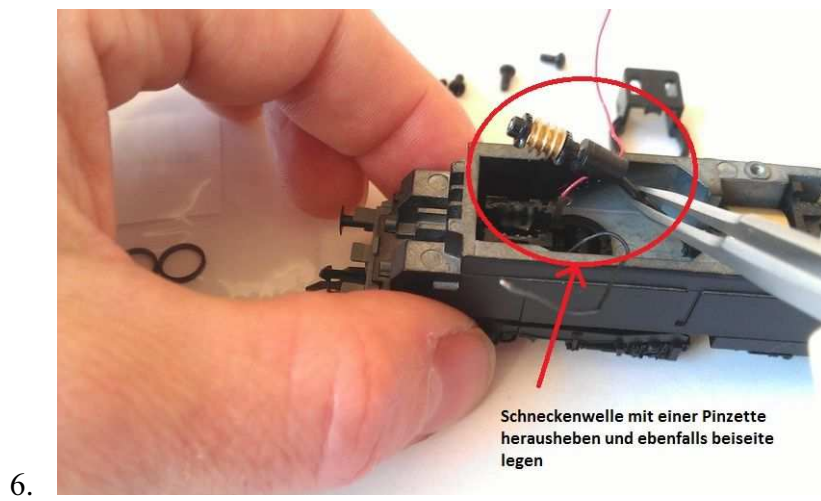
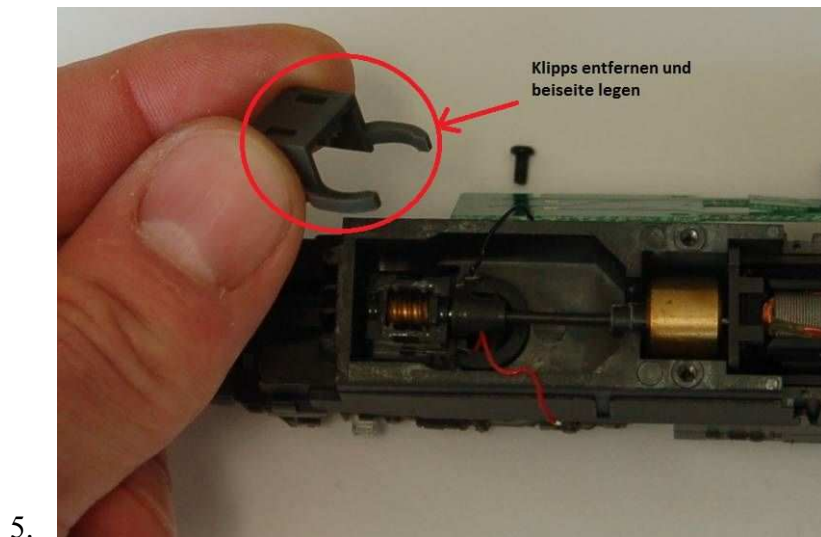

Der Haftreifenwechsel

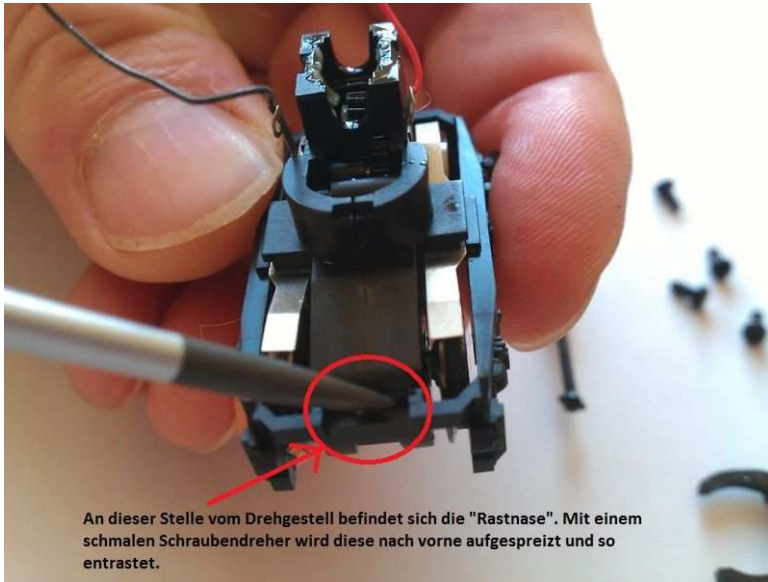

8.



9.

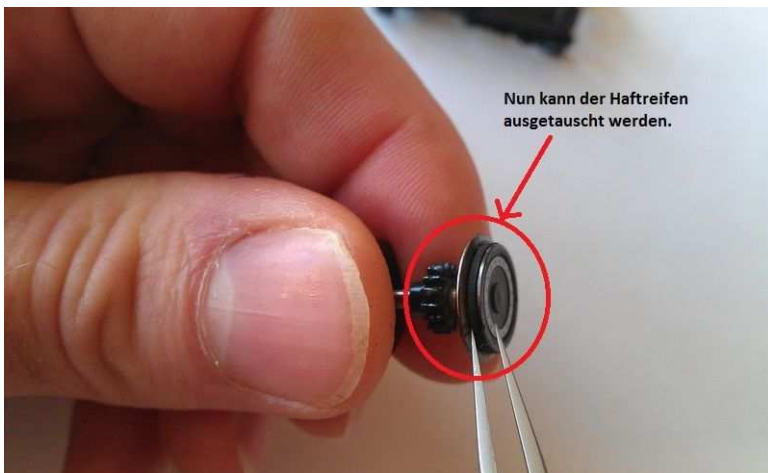

10.

Der Haftreifenwechsel

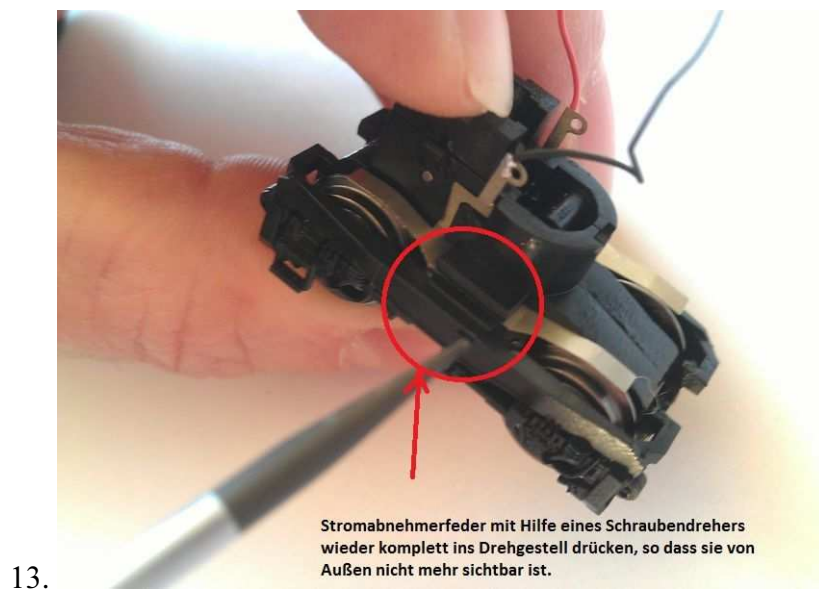
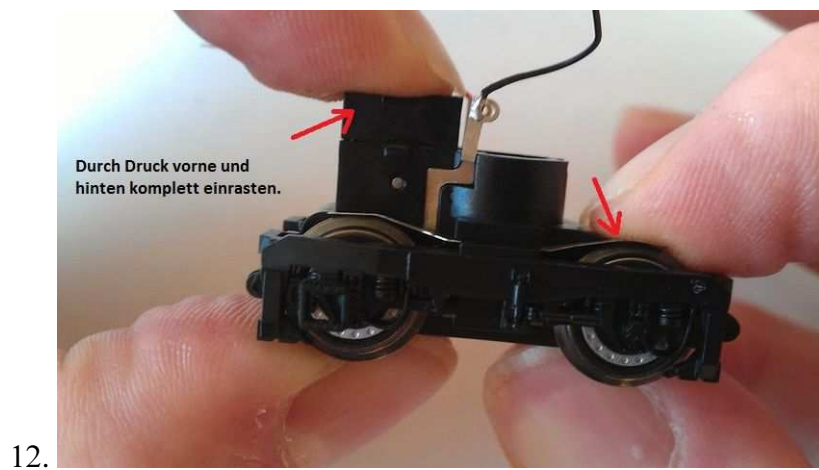

Der Haftreifenwechsel

Drehgestell von unten wieder in den Lokrahmen einsetzen und die Kabel dabei mit durchführen.

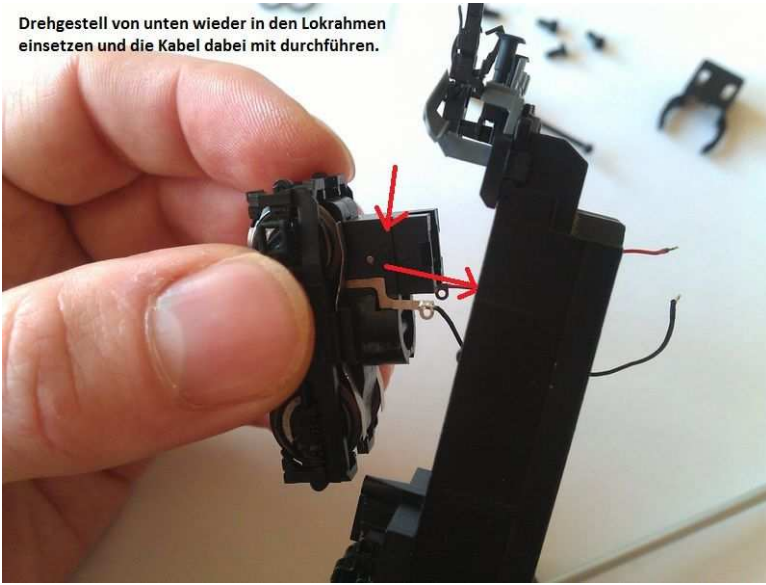

14.

Schneckenwelle vorsichtig wieder einsetzen.

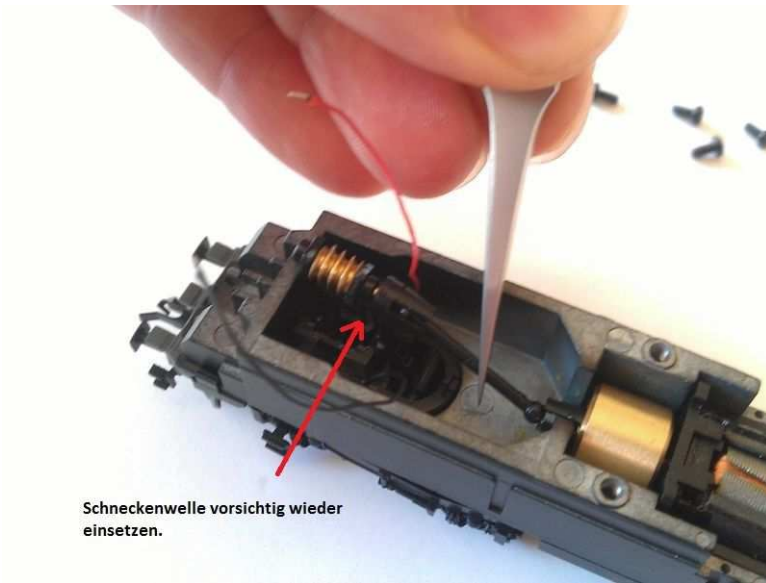

15.

Drehgestellklipps auf beiden Seiten fest einrasten



16.

Der Haftreifenwechsel

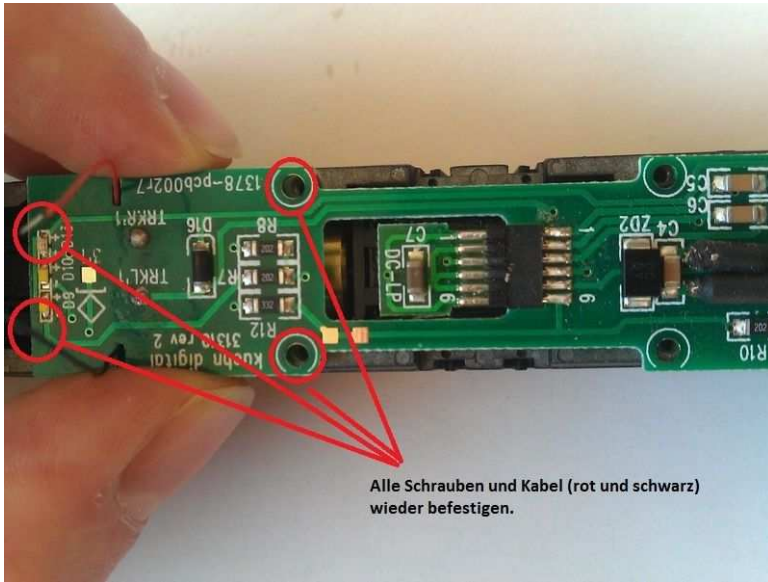

17.

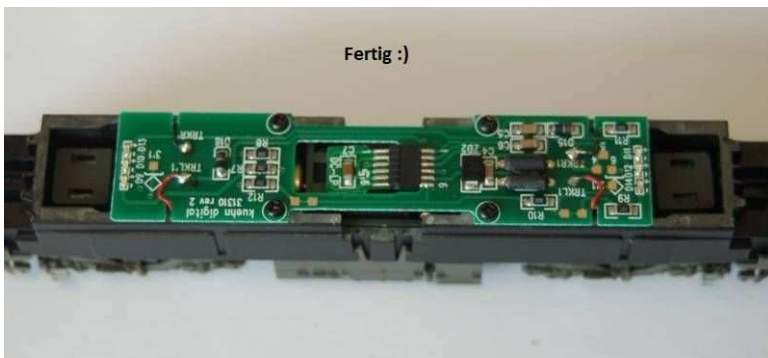

18.